

Supreme
Caravans

MODELS
2018



Supreme Caravans

Supreme Caravans are a family owned company who have been actively involved with the leisure industry manufacturing and selling quality Australian built Caravans for over 30 years. From the company's humble beginnings where the first models were built in a small workshop, Supreme has swiftly grown to one of the industry's leading manufacturers based in 5 state of the art factories in Campbellfield, Victoria.

Supreme Caravans has earned it's reputation of quality and toughness over the years by building the renowned Getaway & Territory range of off road units for 4 wheel drive enthusiasts. This reputation has been further enhanced in recent years by the introduction of touring models including Spirit , Executive and Classic plus the luxurious Slide Out and Base Camp range of products now covering the gambit of semi off road, touring and luxury R.Vs to satisfy all sections of the caravan fraternity.

Supported by long established and reliable dealerships in every state, and with service agents in all parts of Australia, Supreme not only guarantee their product but also ensure service is available wherever you may be.

Supreme Caravans has stood the test of time and will continue to be an innovator and marker leader within the industry long into the future.

So if you are seeking luxury, elegance and style Live your life, live your dream, live Supreme!

DEALERS

NEW SOUTH WALES/QUEENSLAND



Australian Caravan Centre
157-161 Minjungbal Dr Tweed Heads South, 2486 Australia
Ph 07 6010138
sales@australiancaravancentre.com.au

SOUTH AUSTRALIA



Dave Benson Caravans
62-66 Grand Junction Rd, KILBURN SA 5085
Ph 08 8262 2500 | Fax 08 8262 2243
sales@davebensoncaravans.com.au

VICTORIA

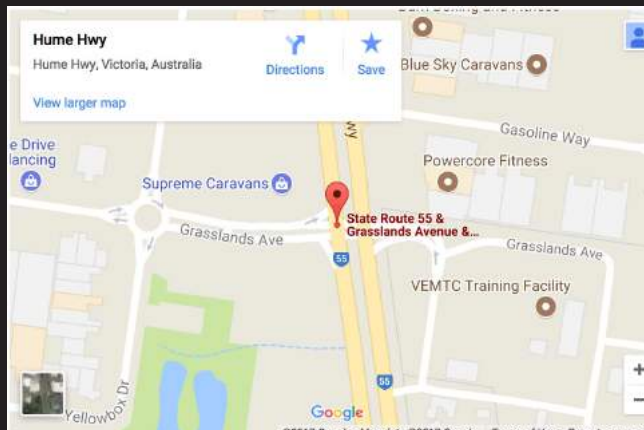

Supreme Caravan Sales Melbourne
Cnr Hume Hwy & Grasslands Ave, Craigieburn VIC 3064
Ph 03 9357 3555 | Fax 03 8339 4867
enquiries@supremecaravans.com.au

WESTERN AUSTRALIA



George Day Caravans
1950 Albany Hwy Maddington WA 6109
Ph 08 9493 5557 | Fax 08 9493 5558
sales@georgeday.com.au

2018 *CLASSIC*



Classic Specifications

CHASSIS & EXTERNAL

- 6-inch box section chassis rail
- A Frame 6-inch box section
- Roller Rocker load sharing suspension
- Electric brakes to all wheels with breakaway unit compatible to all state regulations
- 15-inch alloy rims and tyres
- 50mm hitch
- Hot dipped galvanised 4 arm bumper for extra strength .
- 1 x Spare tyre 15 inch matching alloy
- 2 x Water tanks with separate fillers and water tank gauges
- 2 x gas bottles
- Pull out steel step
- Caravan jack with fitted jacking points on chassis
- Tie down points on chassis
- Drop down weight bearing stabilizer legs
- Tap on a frame (protected)
- Custom aerodynamic shape
- Double glazed windows
- Front window (on appropriate models)
- Triple lock main door with fly screen
- Front boot (on appropriate models)
- Tunnel boot
- Checker plate pebble guard (mill finish)
- Checker plate sides (mill finish)
- Double ribbed extra strong aluminium cladding (white)
- Fully insulated
- 1 x Roof hatch
- 2 x Power hatches (on appropriate models)
- External picnic table
- Dometic 8300 awning
- Double width J mould for extra strength
- Aluminium H frame to A/C for added strength

- Meranti timber frame
- 12mm ply floor membrane coated
- TV roof antenna
- External LED awning lights
- Boot light
- LED tail lights
- External marine grade speakers
- External 240V point
- External 12V point
- Explorer plug (suitable for manual satellite dishes)
- External mobile solar panel connector point
- LED grab handle
- 1 x 120W solar panel roof mounted

APPLIANCES & ELECTRICAL

- Full swift oven with grill and 3 gas/1 elec top (laminex lid)
- 12V flush mounted vented range hood with external venting
- 23LTR Microwave
- Dometic 190LTR double door fridge with fridge fan and through roof flu venting for maximum ventilation
- DVD/MPS/WAV/Audio/Radio player with USB connection and two speakers
- Quick release TV arm
- Ibis 3 slim line true reverse cycle A/C whisper quiet with cabin climate control and remote
- Top loader washing machine (on appropriate models)
- Extra large 28LTR stainless steel gas/electric HWS with in cabin ignition for both gas and electric operation
- Ceramic swivelling toilet
- High powered charger and transformer with 8mm



- wiring for maximum charge individually fused
- 1x 97AMP deep cycle battery
- 1 x 120W solar panel roof mounted
- High powered solar controller with digital battery monitor display
- Anderson plug and 12 pin plug for accelerated charging with 6mm wiring for optimum fridge operation on 12V
- Double power point to kitchen and ensuite
- Bed side power point
- 12V power point under dinette
- 240V power point under dinette
- LED water tank gauges
- 12V water pump

INTERNAL

- Light weight 12mm ply furniture
- Interlocking tongue and groove furniture
- Leatherette trim
- Aluminium overhead doors in seating and dinette (optional)
- High density foam upholstery
- One piece moulded shower
- Fully integrated kitchen with drawers
- House hold tapware and sink
- Ceramic ensuite basin
- Positive lock handles
- Internal LED lights
- Led reading lights to bedroom and dinette
- Lift up bed on struts with triple ply reinforced bed frame
- 1500 x 1800 innerspring mattress + zip on bolster

NOTES: PRODUCT SPECIFICATIONS ARE SUBJECT TO CHANGE WITHOUT NOTICE TO IMPROVE FUNCTION, DESIGN OR OTHERWISE.



2018 *CLASSIC* TOURER



Supreme Tourer

Add On Pack

- All standard Classic Specifications are included
- Full gloss furniture
- Thetford N604 fridge
- Black checker plate
- A choice of either Cristal silver cladding or aluminium composite panel (Silver or White)



2018 *Base Camp*



Basecamp Specifications

CHASSIS & EXTERNAL

- 6-inch box section chassis rail
- A Frame 6-inch box section extended to spring hangers with reinforcing stress plates
- 150mm chassis riser to axle
- Roller Rocker load sharing suspension
- Electric brakes to all wheels with breakaway unit compatible to all state regulations
- 15-inch alloy rims and tyres
- 50mm hitch
- Hot dipped galvanised 4 arm bumper for extra strength
- 1 x Spare tyre 15 inch matching alloy
- 2 x Water tanks with separate fillers and water tank gauges
- 2 x Gas bottles
- Pull out steel step
- Mesh on A frame
- Caravan jack with fitted jacking points on chassis
- Tie down points on chassis
- Drop down weight bearing stabilizer legs
- Tap on a frame (protected)
- Custom aerodynamic shape
- Double glazed windows
- Front window (on appropriate models)
- Triple lock main door with fly screen
- Front boot (on appropriate models)
- Tunnel boot
- Checker plate pebble guard (black powder coated)
- 500mm Checker plate sides (black powder coated)
- Double ribbed extra strong aluminium cladding (white or silver)
- Fully insulated
- 2 x Roof hatch
- 3 x Power hatches (on appropriate models)
- External picnic table
- Dometic 8300 awning
- Double width J mould for extra strength
- Aluminium H frame to A/C for added strength
- Meranti timber frame
- 12mm ply floor membrane coated
- Digital TV roof antenna
- External shower

- External gas bayonet
- External LED awning lights
- Front LED light for hitching up at night
- Offside LED awning light for offside lighting
- Boot light
- LED tail lights
- External marine grade speakers
- External TV box
- External 240V point
- External 12V point and USB point
- Explorer plug (suitable for manual satellite dishes)
- External mobile solar panel connector point
- LED grab handle
- 1 x 120W solar panel roof mounted

APPLIANCES & ELECTRICAL

- Full swift oven with grill and 3 gas/1 elec top (laminex lid)
- 12V flush mounted vented range hood with external venting
- 23LTR Microwave
- Dometic 184LTR double door tropical rated fridge with fridge fan and through roof flu venting for maximum ventilation
- DVD/MPS/WAV/Audio/Radio player with USB connection and two speakers
- Quick release TV arm
- Ibis 3 slim line true reverse cycle A/C whisper quiet with cabin climate control and remote
- Extra large 28LTR stainless steel gas/electric HWS with in cabin ignition for both gas and electric operation
- Ceramic swivelling toilet
- 1 x 97AMP deep cycle battery
- 1 x 120W solar panel roof mounted
- High powered solar controller with digital battery monitor display
- Anderson plug and 12 pin plug for accelerated charging with 6mm wiring for optimum fridge operation on 12V

- Double power point to kitchen and ensuite
- Bed side power point
- 12V power point and USB point under dinette
- 240V power point under dinette
- Freeview HV TV antenna
- LED water tank gauges
- 12V water pump

INTERNAL

- Light weight 15mm gloss furniture
- Aluminium overhead doors in seating and dinette (optional)
- Interlocking tongue and groove furniture
- Leatherette trim
- High density foam upholstery
- Adjustable table leg (on appropriate models)
- One piece moulded shower
- Fully integrated kitchen with drawers
- House hold tapware and sink
- Bathroom pack (towel rail & toilet roll holder)
- Ceramic ensuite basin
- Choice of positive lock handles
- LED downlights
- Internal LED lights
- Led reading lights to bedroom and dinette
- Bedroom robes with bedside nooks
- Lift up bed on struts with triple ply reinforced bed frame
- 1500 x 1980 queens sized innerspring mattress

NOTES: PRODUCT SPECIFICATIONS ARE SUBJECT TO CHANGE WITHOUT NOTICE TO IMPROVE FUNCTION, DESIGN OR OTHERWISE.



2018 EXECUTIVE



Executive Specifications

CHASSIS & EXTERNAL

- 6-inch box section chassis rail
- A Frame 6-inch box section extended to spring hangers with reinforcing stress plates
- Roller Rocker load sharing suspension
- Electric brakes to all wheels with breakaway unit compatible to all state regulations
- 16-inch alloy rims and tyres
- 50mm hitch
- Hot dipped galvanised 4 arm bumper for extra strength
- 1 x Spare tyre 16 inch matching alloy
- 2 x Water tanks with separate fillers and water tank gauges
- 2 x Gas bottles
- Pull out aluminium step with light
- Mesh on A frame
- Caravan jack with fitted jacking points on chassis
- Tie down points on chassis
- Drop down weight bearing stabilizer legs
- Tap on a frame (protected)
- TB01 Toolbox
- Custom aerodynamic shape
- Double glazed windows
- Front window (on appropriate models)
- Triple lock main door with fly screen
- Front boot (on appropriate models)
- Tunnel boot
- Checker plate pebble guard (black powder coated)
- 800mm Checker plate sides (black powder coated)
- Double ribbed extra strong aluminium cladding or Aluminium composite panel (white or silver)
- Fully insulated
- 2 x Roof hatch
- 2 x Power hatches (on appropriate models)
- External picnic table
- Dometic 8300 awning
- Double width J mould for extra strength
- Aluminium H frame to A/C for added strength
- Meranti timber frame
- 12mm ply floor membrane coated
- Digital TV roof antenna

- External gas bayonet
- External LED awning lights
- Front LED light for hitching up at night
- Offside LED awning light for offside lighting
- Boot light
- LED tail lights
- External marine grade speakers
- External TV box
- External 240V point
- External 12V point and USB point
- Explorer plug (suitable for manual satellite dishes)
- External mobile solar panel connector point
- LED grab handle
- 1x 120W solar panel roof mounted

APPLIANCES & ELECTRICAL

- Full swift oven with grill and 3 gas/1 elec top (laminex lid)
- 12V flush mounted vented range hood with external venting
- 23LTR Microwave
- Dometic 184LTR double door tropical rated fridge with fridge fan and through roof flu venting for maximum ventilation
- DVD/MPS/WAV/Audio/Radio player with USB connection and two speakers
- Quick release TV arm
- Ibis 3 slim line true reverse cycle A/C whisper quiet with cabin climate control and remote
- 4KG front loader washing machine (on appropriate models)
- Extra large 28LTR stainless steel gas/electric HWS with in cabin ignition for both gas and electric operation
- Bathroom pack (towel rail & toilet roll holder)
- Ceramic swivelling toilet
- 1 x 97AMP deep cycle battery on chassis rail
- 1x 120W solar panel roof mounted
- High powered solar controller with digital battery monitor display

- Anderson plug and 12 pin plug for accelerated

charging with 6mm wiring for optimum fridge operation on 12V

- Double power point to kitchen and ensuite
- Bed side power point
- 12V power point and USB point under dinette
- 240V power point under dinette
- Sensar HV Freeview digital TV antenna
- Reversing camera
- LED water tank gauges
- LED strip light around door step
- 12V water pump

INTERNAL

- Light weight 15mm gloss furniture
- Waterfall benchtops to kitchen and vanity
- Aluminium overhead doors in seating and dinette (optional)
- Interlocking tongue and groove furniture
- Leatherette trim
- High density foam upholstery
- Adjustable table leg (on appropriate models)
- One piece moulded shower
- Fully integrated kitchen with drawers
- House hold tapware and sink
- Ceramic ensuite basin
- Choice of positive lock handles
- LED downlights
- Internal LED lights
- Led reading lights to bedroom and dinette
- Bedroom robes with bedside nooks
- Lift up bed on struts with triple ply reinforced bed frame
- 1500 x 1980 queen size innerspring mattress

NOTES: PRODUCT SPECIFICATIONS ARE SUBJECT TO CHANGE WITHOUT NOTICE TO IMPROVE FUNCTION, DESIGN OR OTHERWISE.



2018 Spirit



Spirit Specifications

CHASSIS & EXTERNAL

- 6-inch box section chassis rail
- A Frame 6-inch box section extended to spring hangers with reinforcing stress plates + 300mm front extension
- 150mm riser to axels
- Roller Rocker load sharing suspension
- Electric brakes to all wheels with breakaway unit compatible to all state regulations
- 15-inch alloy rims and tyres
- 50mm hitch
- Hot dipped galvanised 4 arm bumper for extra strength
- 1 x Spare tyre 15 inch matching alloy
- 2 x Water tanks with separate fillers and water tank gauges
- 2 x Gas bottles
- Pull out aluminium step with light
- Mesh on A frame
- Caravan jack with fitted jacking points on chassis
- Tie down points on chassis
- Drop down weight bearing stabilizer legs
- Tap on a frame (protected)
- Custom aerodynamic shape
- Double glazed windows
- Front window & rear window (on appropriate models)
- Triple lock main door with fly screen
- Tunnel Boot
- Front boot (on appropriate models)
- Full front and rear tunnel boot (on appropriate models)
- Checker plate pebble guard (black powder coated)
- 500mm Checker plate sides (black powder coated)
- Double ribbed extra strong aluminium cladding or Aluminium composite panel (white or silver)
- Fully insulated
- 2 x Roof hatch
- 2 x Power hatches (on appropriate models)
- External picnic table
- Dometic 8300 awning
- Double width J mould for extra strength
- Aluminium H frame to A/C for added strength
- Meranti timber frame
- 12mm ply floor membrane coated
- Digital TV roof antenna

- External gas bayonet
- External LED awning lights
- Front LED light for hitching up at night
- Offside LED awning light for offside lighting
- Boot light
- LED tail lights
- External marine grade speakers
- External TV box
- External 240V point
- External 12V point and USB point
- Explorer plug (suitable for manual satellite dishes)
- External mobile solar panel connector point
- LED grab handle
- 1 x 120W solar panel roof mounted

APPLIANCES & ELECTRICAL

- Full swift oven with grill and 3 gas/1 elec top (laminex lid)
- 12V flush mounted vented range hood with external venting
- 23LTR Microwave
- Dometic 184LTR double door fully automated fridge with fridge fan and through roof flu venting for maximum ventilation
- Touchscreen BT/USB/Audio-Video and two speakers
- Quick release TV arm
- Ibis 3 slim line true reverse cycle A/C whisper quiet with cabin climate control and remote
- 4kg front loader washing machine tower (on appropriate models)
- Extra large 28LTR stainless steel gas/electric HWS with in cabin ignition for both gas and electric operation
- Bathroom pack (towel rail & toilet roll holder)
- Ceramic swivelling toilet
- 1 x 97AMP deep cycle battery on chassis rail
- 1x 120W solar panel roof mounted

- High powered solar controller with digital battery monitor display
- Anderson plug and 12 pin plug for accelerated charging with 6mm wiring for optimum fridge operation on 12V
- Double power point to kitchen and ensuite
- Bed side power point
- 12V power point and USB point under dinette
- 240V power point under dinette
- Sensar HV Freeview digital TV antenna
- LCD multi display water tank gauges
- 12V water pump
- Slide out BBQ

INTERNAL

- Light weight 15mm gloss furniture
- Waterfall benchtops to kitchen and vanity
- Aluminium overhead doors in seating and dinette (optional)
- Interlocking tongue and groove furniture
- Leatherette trim
- High density foam upholstery
- Adjustable table leg (on appropriate models)
- One piece moulded shower
- Fully integrated kitchen with drawers
- House hold tapware and sink
- Ceramic ensuite basin
- Choice of positive lock handles
- LED downlights
- Internal LED lights
- Led reading lights to bedroom and dinette
- Bedroom robes with bedside nooks
- Lift up bed on struts with triple ply reinforced bed frame
- 1500 x 1980 queen size innerspring mattress

NOTES: PRODUCT SPECIFICATIONS ARE SUBJECT TO CHANGE WITHOUT NOTICE TO IMPROVE FUNCTION, DESIGN OR OTHERWISE.



TERRITORY

2018



Territory Specifications

CHASSIS & EXTERNAL

- 6-inch box section hot dipped galvanised chassis rail
- A Frame 6-inch box section + 300mm front extension
- suspension
- Electric brakes to all wheels with breakaway unit compatible to all state regulations
- 16-inch alloy rims and off road/all terrain tyres
- D035 hitch
- Hot dipped galvanised 4 arm bumper for extra strength (120kg rated)
- 1 x Spare tyre 16 inch matching alloy
- 2 x Jerry can holders
- 3 x Water tanks with separate fillers and water tank gauges
- 2 x Gas bottles
- Pull out aluminium step with light
- Mesh on A frame
- Stoneguard on A frame
- Caravan jack with fitted jacking points on chassis
- Tie down points on chassis
- Drop down weight bearing stabilizer legs
- Tap on a frame (protected)
- Generator box on A frame
- Custom aerodynamic shape
- Double glazed windows
- Front window & rear window (on appropriate models)
- Triple lock main door with fly screen
- Front boot (on appropriate models)
- Tunnel boot
- Checker plate pebble guard (black powder coated)
- 500mm Checker plate sides (black powder coated)
- Rear checker plate 1500mm
- Double ribbed extra strong aluminium cladding or Aluminium composite panel (white or silver)
- Fully insulated
- 2 x Roof hatch
- 2 x Power hatches (on appropriate models)
- Pressure hatch
- External picnic table
- Dometic 8300 awning
- Double width J mould for extra strength
- Aluminium H frame to A/C for added strength
- Meranti timber frame
- 12mm ply floor membrane coated
- Galvernised sheet

- Sheathing to all PVC pipes
- Digital TV roof antenna
- External shower
- External gas bayonet
- External LED awning lights
- Front LED light for hitching up at night
- Offside LED awning light for offside lighting
- Boot light
- LED tail lights
- External marine grade speakers
- External TV box
- External 240V point
- External 12V point and USB point
- Explorer plug (suitable for manual satellite dishes)
- External mobile solar panel connector point
- LED grab handle
- 2 x 120W solar panel roof mounted

APPLIANCES & ELECTRICAL

- Full swift oven with grill and 3 gas/1 elec top (laminex lid)
- 12V flush mounted vented range hood with external venting
- 23LTR Microwave
- Dometic 184LTR double door tropical rated fridge with fridge fan and through roof flu venting for maximum ventilation
- Touchscreen BT/USB/Audio-Video and two speakers
- Quick release TV arm
- Ibis 3 slim line true reverse cycle A/C whisper quiet with cabin climate control and remote
- 4kg front loader washing machine tower (on appropriate models)
- Extra large 28LTR stainless steel gas/electric HWS with in cabin ignition for both gas and electric operation
- Bathroom pack (towel rail & toilet roll holder)
- Ceramic swivelling toilet
- 2 x 97AMP deep cycle battery on chassis rail
- 2 x 120W solar panel roof mounted



- High powered solar controller with digital battery monitor display
- Anderson plug and 12 pin plug for accelerated charging with 6mm wiring for optimum fridge operation on 12V
- Double power point to kitchen and ensuite
- Bed side power point
- 12V power point and USB point under dinette
- 240V power point under dinette
- Sensar HV Freeview digital TV antenna
- Reversing camera
- LCD multi display water tank gauges
- 12V water pump

INTERNAL

- Light weight 15mm gloss furniture
- Aluminium overhead doors in seating and dinette (optional)
- Interlocking tongue and groove furniture
- Leatherette trim
- High density foam upholstery
- Adjustable table leg (on appropriate models)
- One piece moulded shower
- Fully integrated kitchen with drawers
- House hold tapware and sink
- Ceramic ensuite basin
- Choice of positive lock handles
- Internal LED downlights
- LED reading lights to bedroom and dinette
- Bedroom robes with bedside nooks
- Lift up bed on struts with triple ply reinforced bed frame
- 1500 x 1980 queen size innerspring mattress

NOTES: PRODUCT SPECIFICATIONS ARE SUBJECT TO CHANGE WITHOUT NOTICE TO IMPROVE FUNCTION, DESIGN OR OTHERWISE.



2018 LAYOUTS

SINGLE AXLE LAYOUTS

LAYOUT: 1700

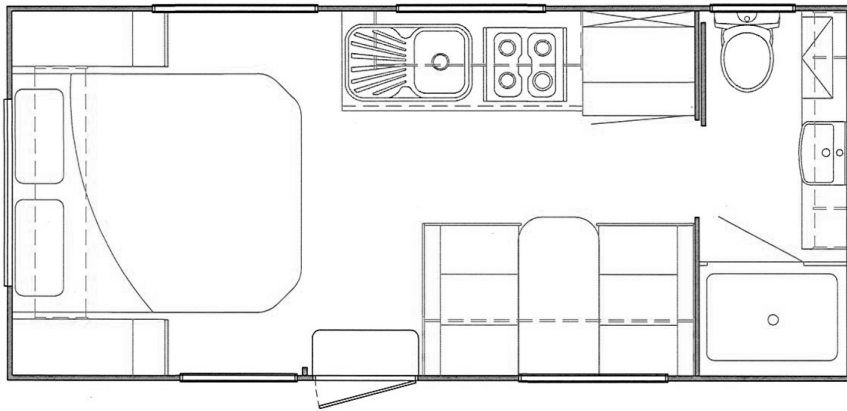

LAYOUT: 1800

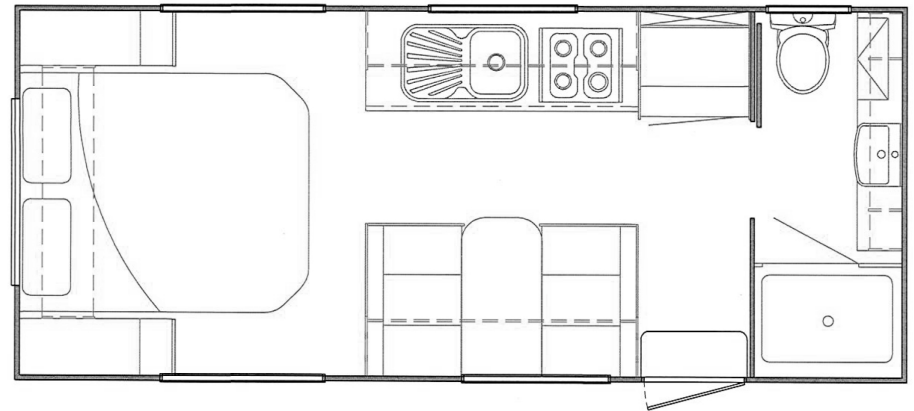

LAYOUT: 1800

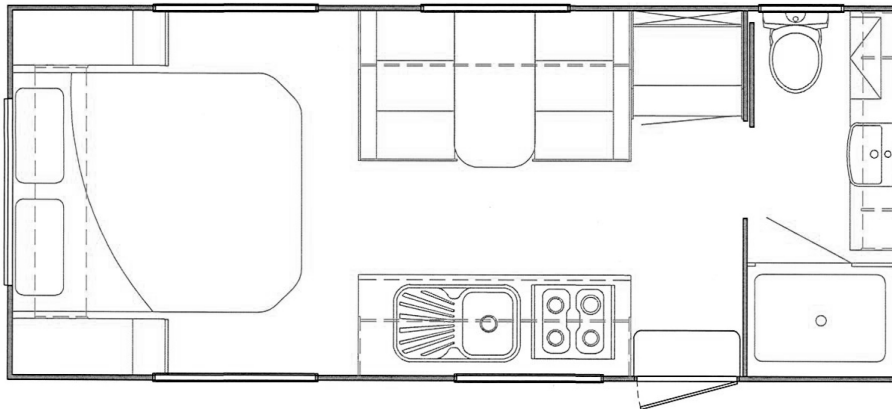

LAYOUT: 1800

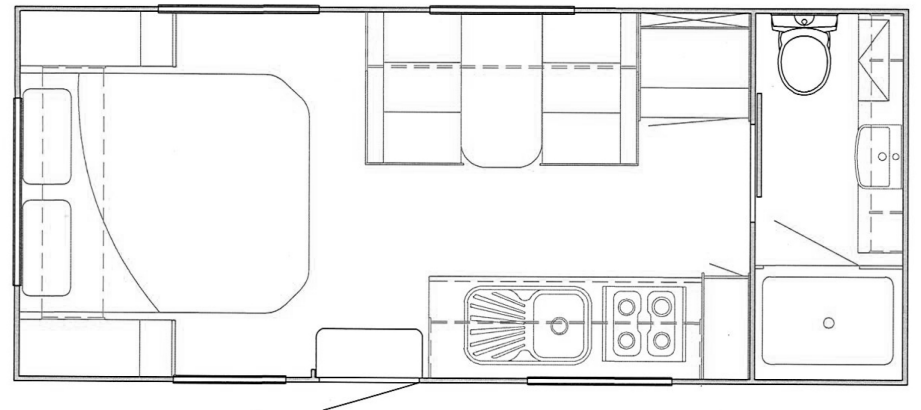

TANDEM LAYOUTS

LAYOUT: 1800

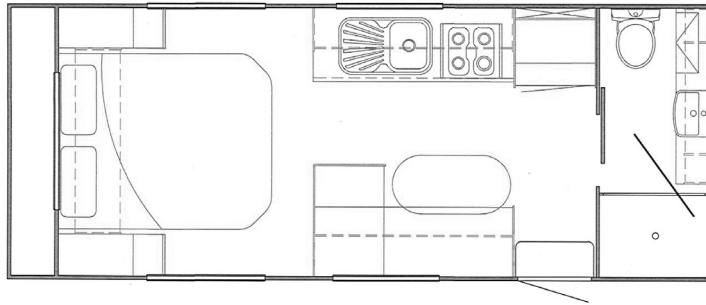

LAYOUT: 1860

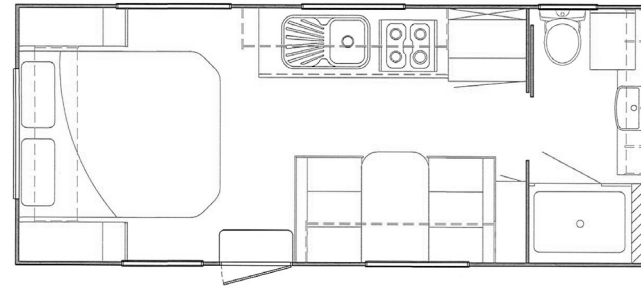

LAYOUT: 1860

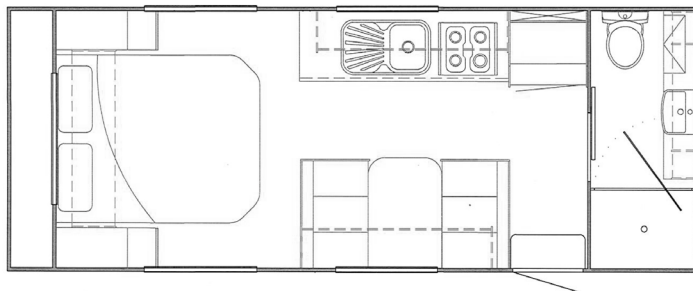

LAYOUT: 1900

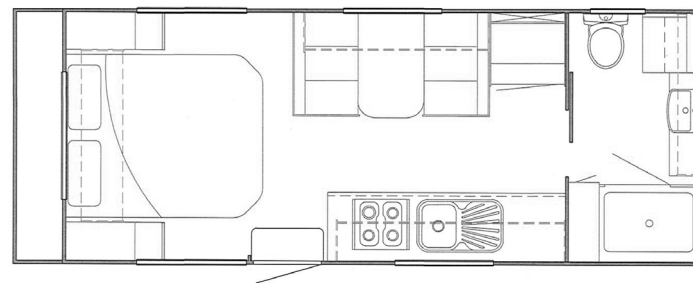

2018 LAYOUTS

TANDEM LAYOUTS

LAYOUT: 1900

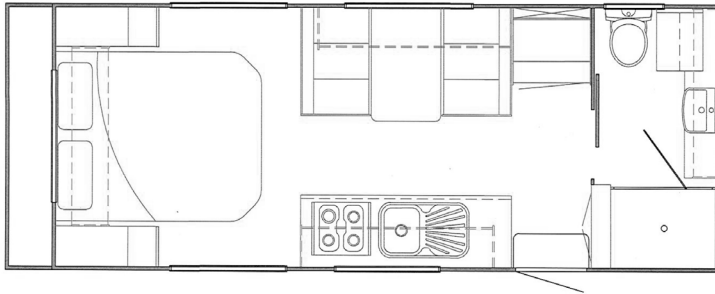

LAYOUT: 1900

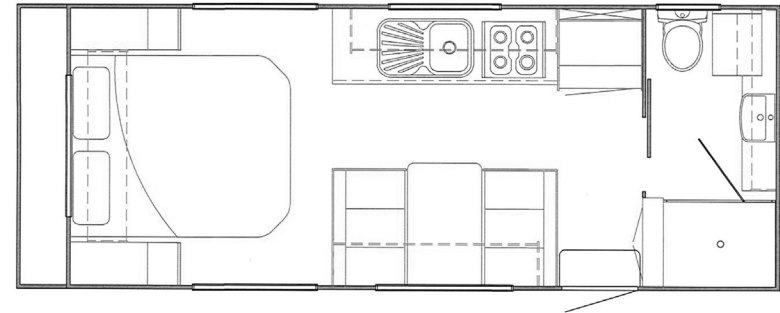

LAYOUT: 1960

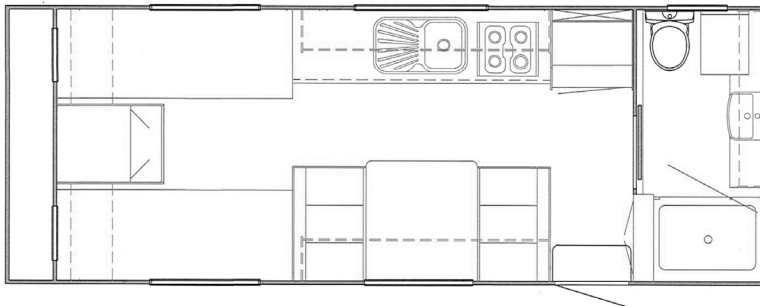

LAYOUT: 1960

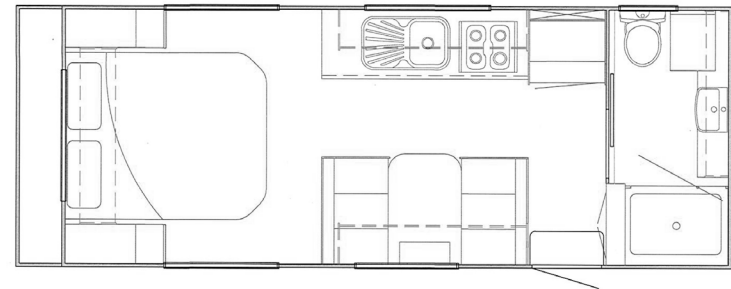

2018 LAYOUTS

TANDEM LAYOUTS

LAYOUT: 1960

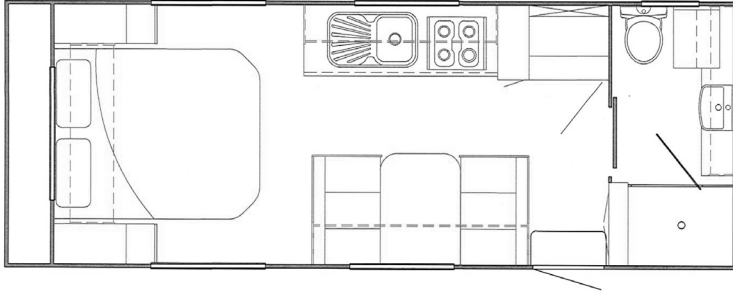

LAYOUT: 2060

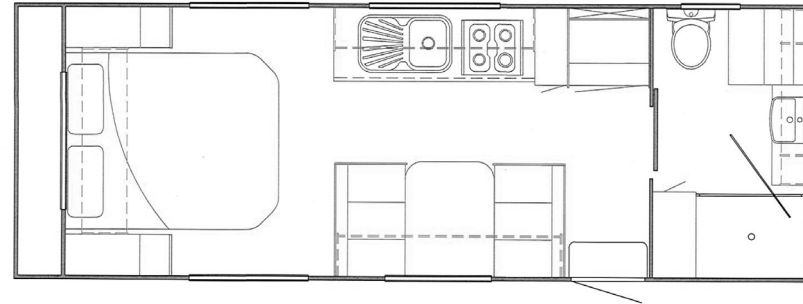

LAYOUT: 2100

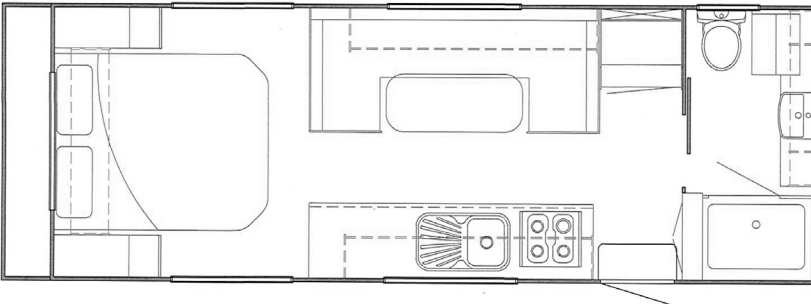

LAYOUT: 2200

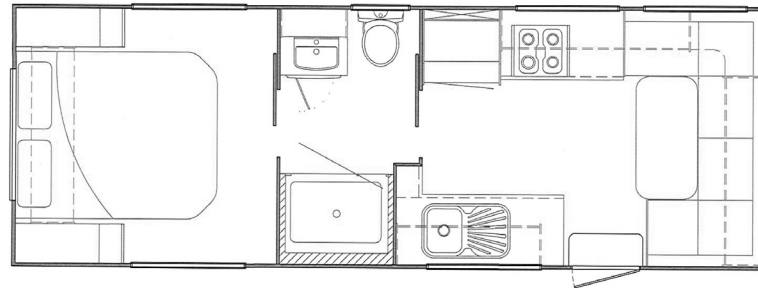

LAYOUT: 2260

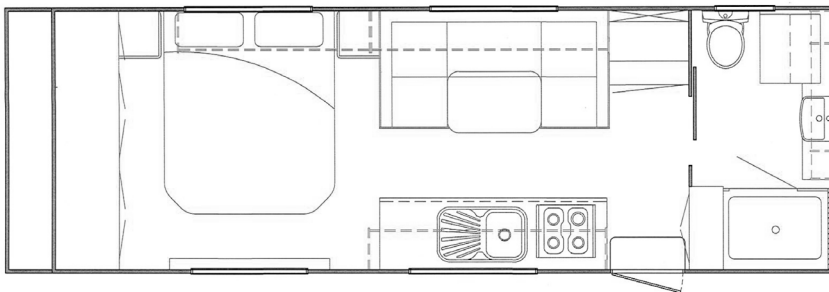

LAYOUT: 2400

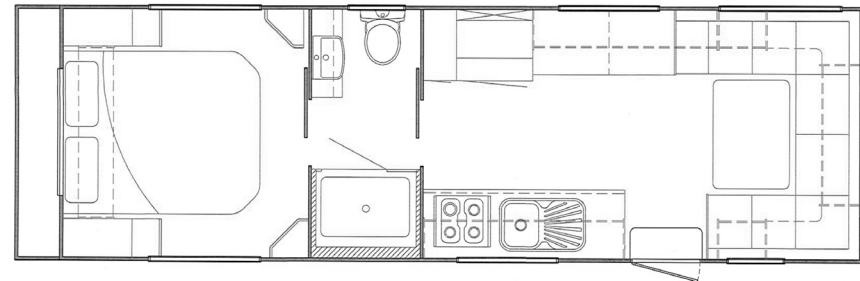

2018 LAYOUTS

FAMILY VAN LAYOUTS

LAYOUT: 1800

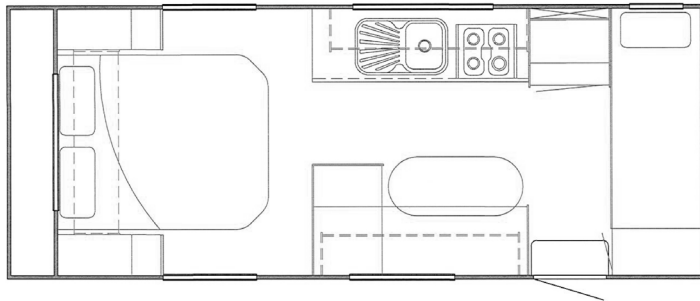

LAYOUT: 1960

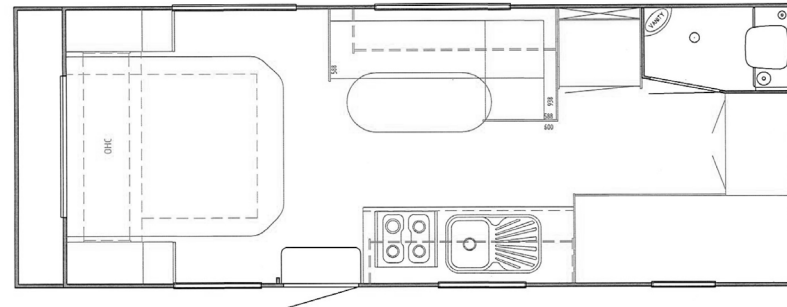

LAYOUT: 2100

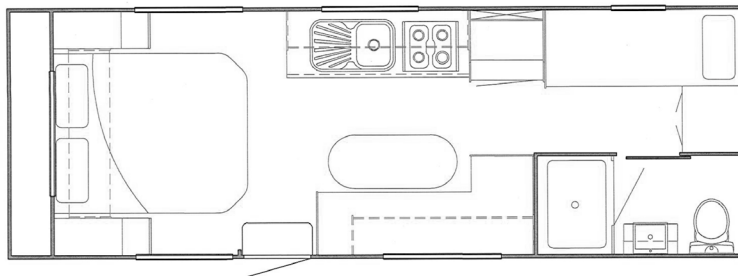

LAYOUT: 2200

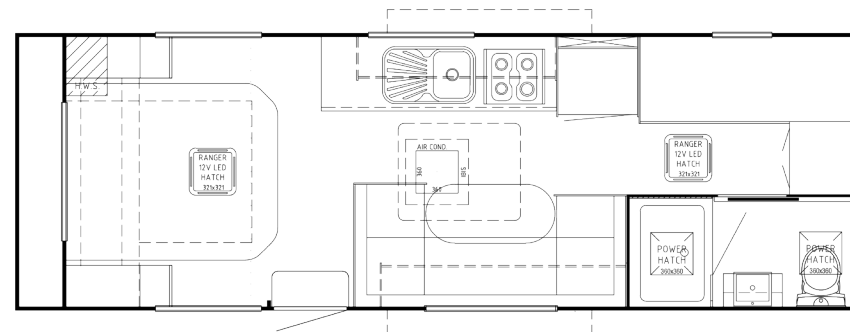

2018 LAYOUTS

2018 LAYOUTS

BASECAMP LAYOUTS

LAYOUT: 2560

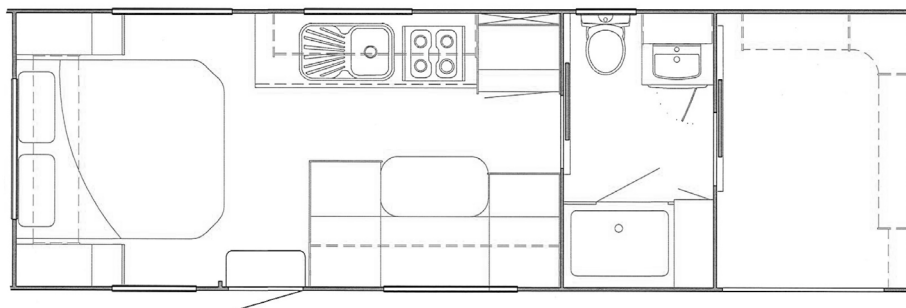

LAYOUT: 2560

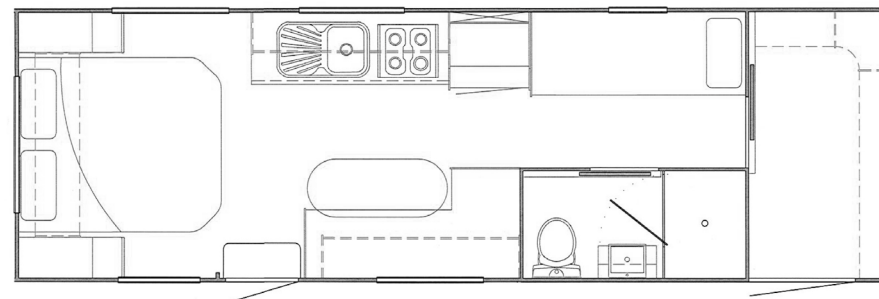

LAYOUT: 2560

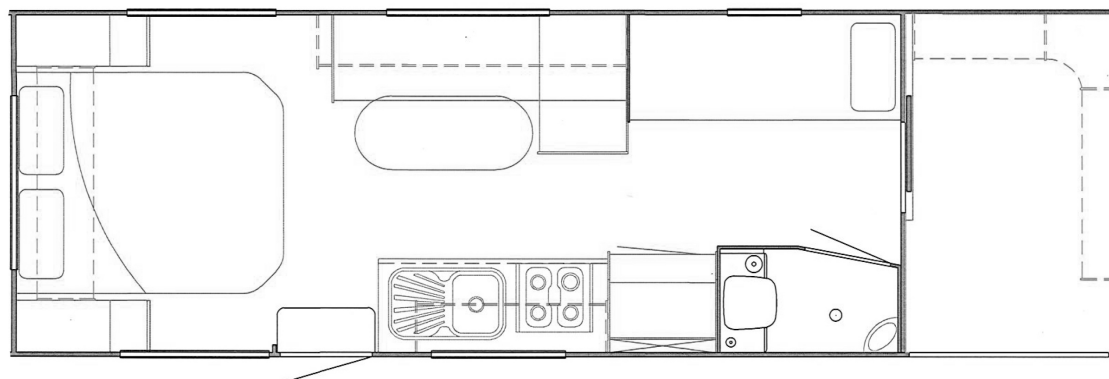

2018 LAYOUTS

SLIDE OUT LAYOUTS

LAYOUT: 2190

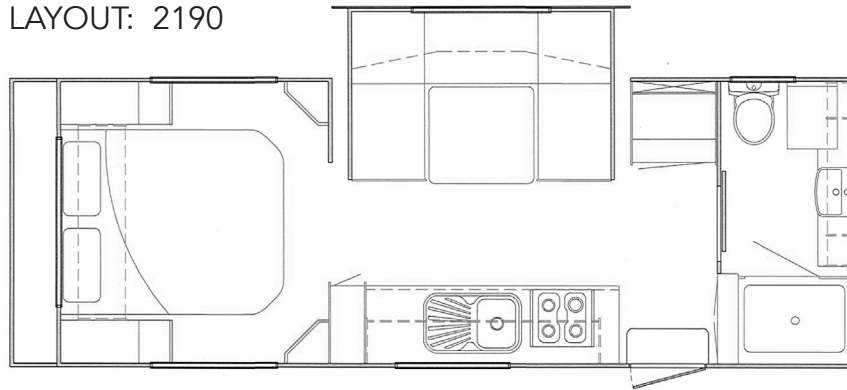

LAYOUT: 2300

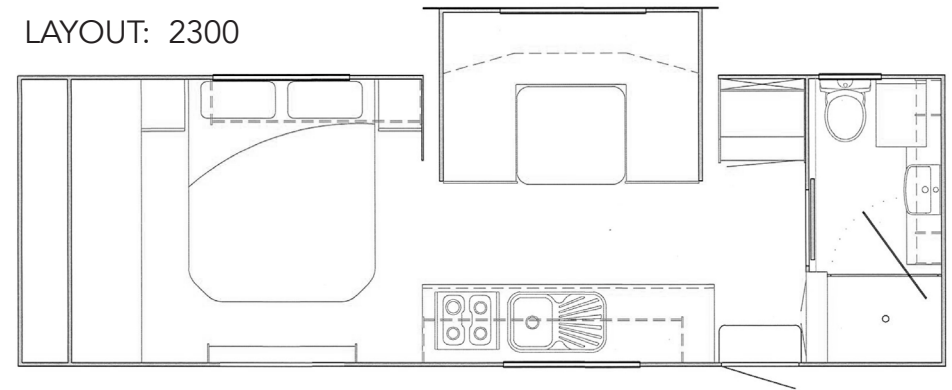

LAYOUT: 2460

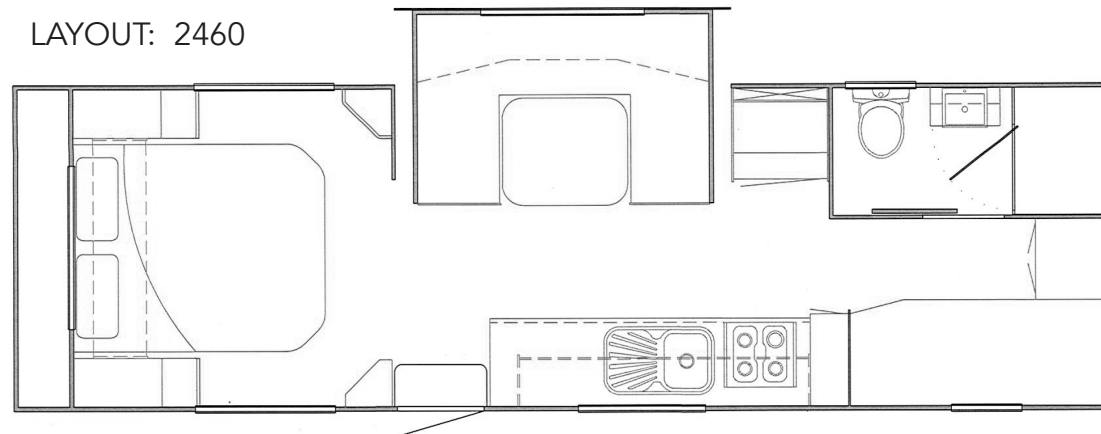

NEW ENSUITE DESIGNS

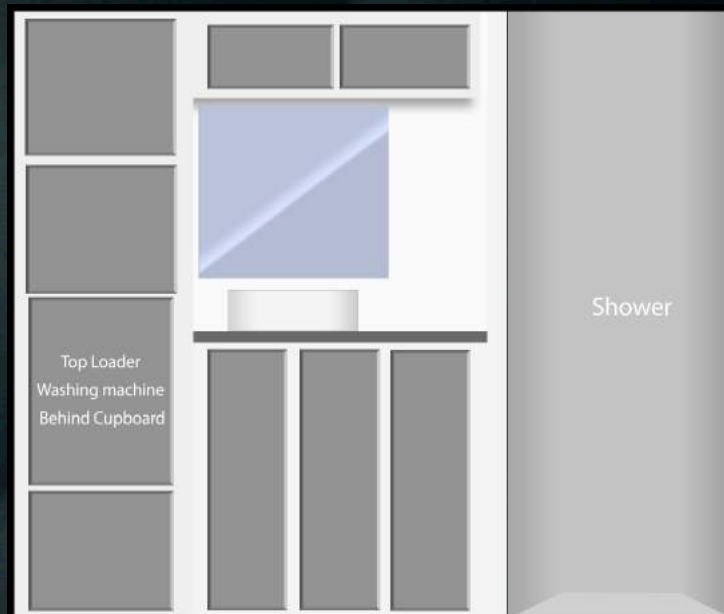

Classic Rear Ensuite Layout

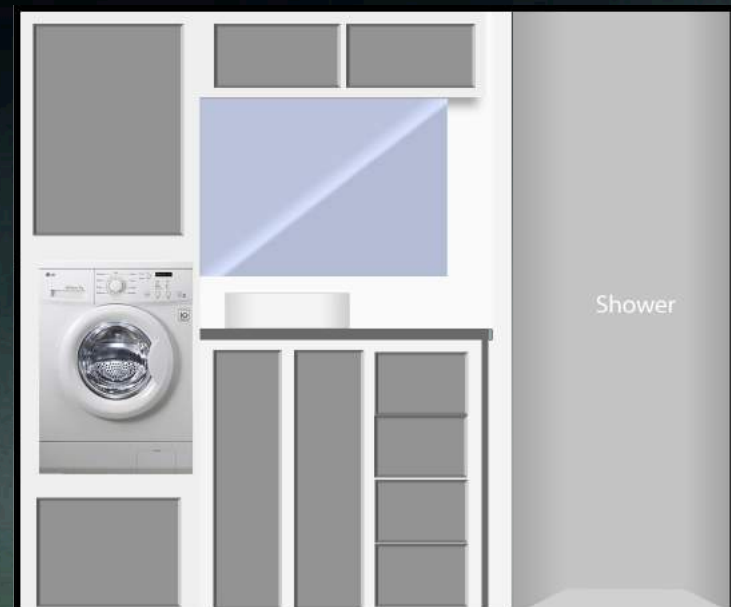

Executive Rear Ensuite Layout

2018 LAYOUTS

WWW.SUPREMECARAVANS.COM.AU

Supreme Caravans